



# Exporting a video from an e-learning

This documentation will explain how to convert an e-learning into a video via the Producer. This involves playing the e-learning and recording it simultaneously. The resulting video can then be saved in the WebM or MP4 format.

The Producer in tts performance suite can be used to play back an e-learning and record it as a WebM video. And, if you have an appropriate encoder, you can also create an MP4 file from the WebM video. (See below: *User preferences for the video export*)

## 1 Recording the e-learning

When the Video Exporter is started, the e-learning for the corresponding document is accessed and opened in a separate window (1). The video will be recorded in the same **size** as specified in the *document properties* for the *e-learning*.

The setting in the Document Editor allows you to decide whether the e-learning is accessed in the Study or Assessment mode. If you activate the "*Switch the editing view to Assessment mode*" function, the **Assessment mode** will be accessed. If this function is deactivated, the Study mode will be accessed.

When in the **Study mode**, the play mode that was intended for the first step of the e-learning will be accessed. This is specified in the *document properties* for the *e-learning* on the whole or in the actual *step* via the *Individual Play mode* setting in its properties. This also applies for all subsequent steps.

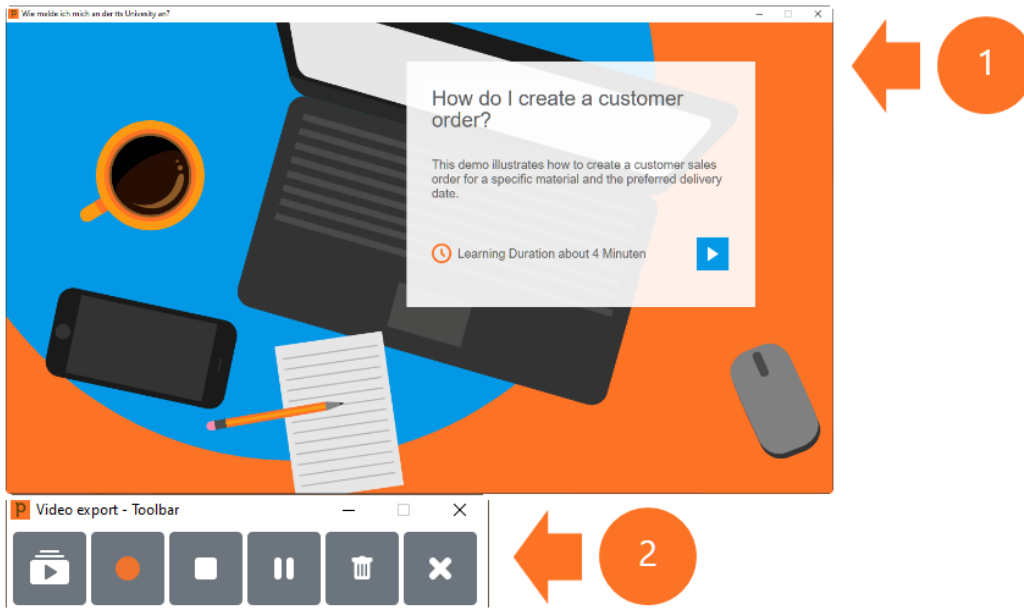

The **toolbar** for the video export (2) is located below the e-learning window by default. It can, however, be positioned anywhere on the screen. The toolbar will not be visible in the subsequent recording, even if it overlaps with the e-learning window.

In cases where the “Start recorder automatically” option is set, the recording will begin as soon as the first step is displayed. Otherwise, you need to start the recording yourself via the toolbar.







What you need to remember when recording:

- The mouse pointer is always included in the recording. Every time the mouse is moved during the recording will be visible in the resulting video.
- Whenever audio is played (e.g. via a streaming service) while recording the e-learning, this audio will also be included in the recording. Every system sound emitted by Windows will also be recorded.
- Your microphone cannot be used as an audio source as things currently stand.
- If you click a hyperlink in the e-learning, your standard browser will open. However, the standard browser will not be included in the recording.

Once you have finished recording, the video will be saved in the specified output folder. (See below: *User preferences for the video export*)

 When you upload the document from which you recorded the e-learning to the Curator, the generated video is not transferred with it. It remains on your computer. However, it's possible to manually make the video available in WebAccess or QuickAccess by uploading it to the Curator from the output folder as a stand-alone document.

## 2 Toolbar of the Recorder

Button	Description and keyboard shortcut (when available)
	Create separate video per step
	Start recording (Ctrl + R)
	Stop recording (Ctrl + S)
	Pause / Continue recording (Ctrl + P)
	Cancel Info: All current recordings will be discarded.
	Exit (Ctrl + Q) Info: Recording will be stopped and the application shuts down.

### 3 User preferences for the video export

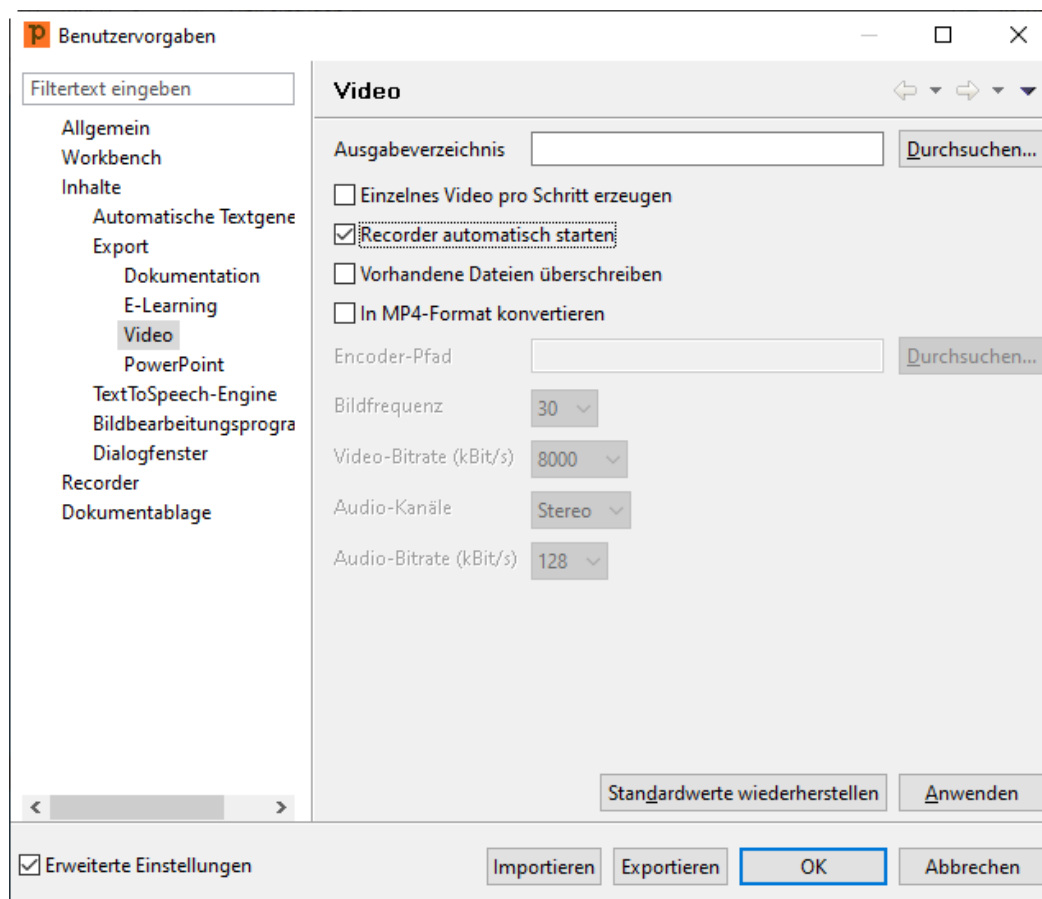

#### Output folder

The output folder is for specifying the folder to which the video is to be automatically saved once you finish recording. If no folder is specified, the video will be stored in a temporary folder along with the temporary export of the e-learning. A new temporary directory is created for each recording procedure. Following the export, you have the option of accessing the storage location directly via the final dialog.

#### Create separate video per step

If you activate this function, the Recorder will create a separate video for each step, saving all videos in numerical order in the temporary folder.

#### Start recorder automatically

When you start the video export, the recording will be automatically started as soon as the first step is displayed. If this option is deactivated, you need to start the recording manually via the toolbar.

#### Overwrite existing files

This option is for specifying whether versions of a video that were exported earlier are to be overwritten. If this function is not activated, all previously exported versions are retained with

consecutive numbering. This function is particularly important if you specified an output folder.

## **Convert to MP4 format**

You have the option of activating the coding of MP4 videos. To do so, you need to specify *FFmpeg* as the **encoder** by entering the **path** to the folder in which *FFmpeg* is saved locally on your computer. The MP4 video will then also be available in the output folder in addition to the WebM video.

With regard to the creation of an MP4 video, you can also specify the **frame rate** and **video bitrate**, along with the **audio channels** and **audio bitrate**.

 *FFmpeg* can be downloaded free of charge from the internet.