



Publishing options for a Producer document

Document properties > This documentation will reveal the publishing options that are available for an e-learning, documentation and guide.

The settings regarding the publishing options can be modified in the document properties of a Producer document. The default settings from the document template initially apply. This is indicated by the fact that the export options are grayed out and are therefore inactive..

If the checkbox next to the "Activate individual settings for the document" field is selected, all the checkboxes become active and the suggested settings for the respective publishing format (documentation, e-learning, guide) can be changed.

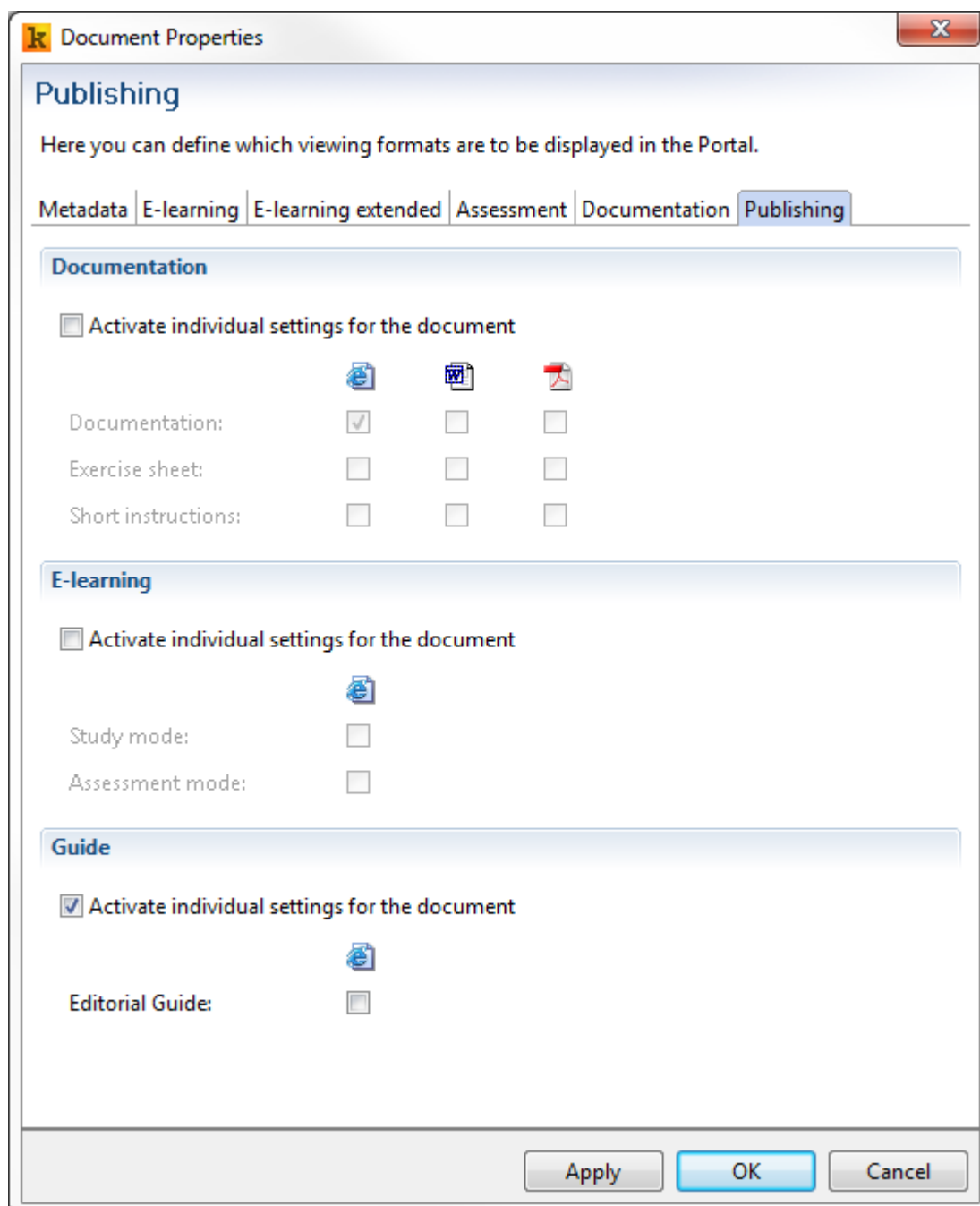

Documentation

Documentation can be published as HTML, Word or PDF. There are basically three different ways of presenting the content:

- The **documentation** can be published on its own – i.e. the entire content is made available in the HTML, Word or PDF format.
- The **exercise sheet** can be used when a procedure has been recorded in an IT application. It is split into two parts:

The first part lists all the data required to execute the transaction that was recorded in the document. The learners can then use these data to perform the procedure in the IT application and check whether they can apply their new knowledge in the real-life

environment.

The second part contains the ideal procedure which explains the transaction in detail, thereby ensuring that the learner really understands the correct procedure.

- The **Short instructions** setting only publishes the interaction instructions and associated screenshots from the documentation in tabular form.

E-learning

E-learnings can be published as HTML in the **Study mode** and/or **Assessment mode**. Please refer to the corresponding help topics to find out more about these two modes.

Guide

Guides can also be published in the HTML format. Only one publishing format is supported here.