

Integration of ChatGPT

1 Introduction

Thanks to the integration of **ChatGPT**, it is now possible to use this service to handle the tasks of text generation, quality assurance and localization during the production process. An API key must be stored on the server side by the administrator as a prerequisite for accessing this service.

2 Which functions are available?

To access the functions of ChatGPT, you first need to create/open a Creator document of the type "D-ID" or "Richtext". If the ChatGPT function has been set up correctly, you will find the corresponding button in the free text fields of these content types:

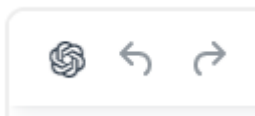

(next to the "Undo / Redo" buttons).

If you click this button , a new window will open:

Chat GPT

Source text

|

Generated text

Task

Translate into document language

Language Style

Neutral

You can enter any text, questions or keywords into the **Source text** field in this window. This input is used as the basis for the subsequent transformation by ChatGPT.

The following transformations are supported (under **Task**):

- **Translate into document language**
Produces a translation of the source text, while taking the set language style into consideration (see below)
- **Proofread**
Improves the text and changes the language style if considered necessary (see below)
- **Write introduction**
Creates continuous text of an introductory nature from keywords
- **Create executive summary**
Summarizes the essential points of the source text.

No matter which transformation you want to perform, you can use the **Language Style** dropdown menu to select the level of language ChatGPT should use, i.e. "how the text should sound" with the target group in mind. Here you can choose between:

Neutral - no particular target group

Formal language - a more sophisticated tone and less familiar

Informal language - everyday language, a more youthful tone

Easy language - uses a more limited vocabulary and simple sentence structure.

 The texts generated by ChatGPT are always in the respective content language of the Creator document.

To create a text, fill in the **Source text** field accordingly, then select the desired **Task** and **Language Style**, and then click the **Generate** button. If you are happy with the result in the **Generated text** field, click the **Apply** button at the bottom edge of the window to copy the generated text into your document. Feel free to experiment with slightly different source texts or another language style. If you want to close the ChatGPT window without copying the generated text to your document, simply click **Cancel**.

3 How to use ChatGPT for steplists

When dealing with the Creator content type "Steplist", the ChatGPT function can be found in the sidebar:

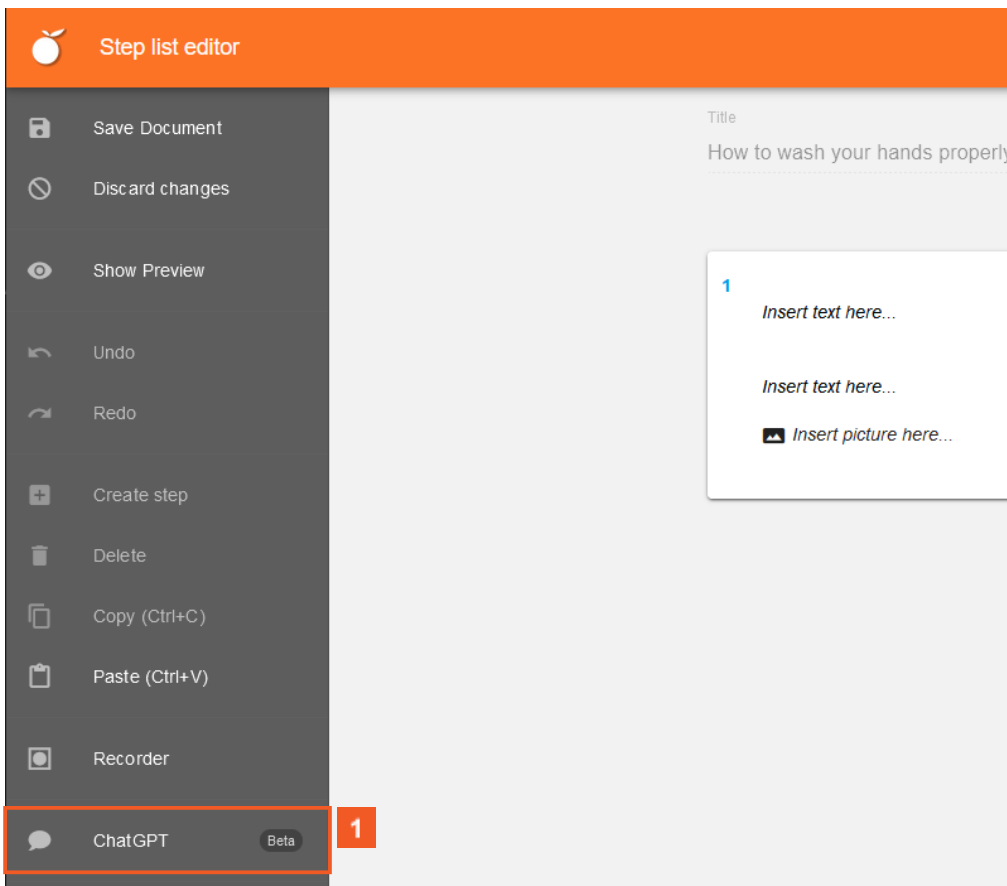

1 Click this button  in the sidebar.

When the button is clicked, a pop-up window appears in which you can enter a question. By default, the input field adopts the title of the document that is currently open.

ChatGPT

Question

How do I wash my hands properly?

2 Beta features are, by their very nature, intended for testing and evaluation. Please be aware that content created by ChatGPT may contain errors or even be completely false and fictitious. Sources cannot be verified.

3

CANCEL APPLY

- 2 Enter a question into the input field.
- 3 Submit the question by clicking the button with the paper airplane icon.

the water is at a comfortable temperature.

Apply soap: Take a sufficient amount of soap (liquid or bar) and lather it in your hands. Ensure that you cover all surfaces of your hands, including the back, between the fingers, and under the nails.

Rub your hands together: Rub your palms together vigorously, creating a soapy lather. Interlace your fingers and rub the back of your hands against each other. Scrub the area between your fingers, and don't forget to clean your thumbs and wrists as well.

Scrub for at least 20 seconds: It is recommended to wash your hands for at least 20 seconds. You can estimate this time by singing the "Happy Birthday" song twice or any other song that lasts around 20 seconds.

Rinse thoroughly: Place your hands under clean, running water to rinse off the soap. Ensure that all the soap is washed away, including from your wrists and between your fingers.

Dry your hands: Use a clean towel or an air dryer to dry your hands thoroughly. If using a towel, pat your hands gently rather than rubbing them vigorously, as excessive rubbing can cause skin irritation.

Turn off the faucet: If possible, use a towel or tissue to turn off the faucet to avoid recontaminating your hands.

Remember to wash your hands at key times, such as before preparing or eating food, after using the restroom, after coughing or sneezing, and after touching surfaces in public areas. Handwashing should be done frequently throughout the day to maintain proper hygiene.

CANCEL ⁵ APPLY ⁴

After a brief wait, the reply from ChatGPT – split into individual sections – will appear. These sections will be transferred to the steplist as individual steps as soon as you click the **Apply** button at the bottom of the window:

- 4** Scroll down to the bottom of the window if necessary.

5 Select the **APPLY** button.

Dry your hands: Use a clean towel or an air dryer to dry your hands thoroughly. If using a towel, pat your hands gently rather than rubbing them vigorously, as excessive rubbing can cause skin irritation.

 *Insert picture here...*



9 Normal

Insert text here...

Normal

Turn off the faucet: If possible, use a towel or tissue to turn off the faucet to avoid recontaminating your hands.

 *Insert picture here...*

10 Normal

Insert text here...

Normal

Remember to wash your hands at key times, such as before preparing or eating food, after using the restroom, after coughing or sneezing, and after touching surfaces in public areas. Handwashing should be done frequently throughout the day to maintain proper hygiene.

 *Insert picture here...*



Just like in all other Creator steplists, you can now further edit the steps – for example by adding additional text or images, copying the steps, rearranging them or deleting unnecessary steps.